

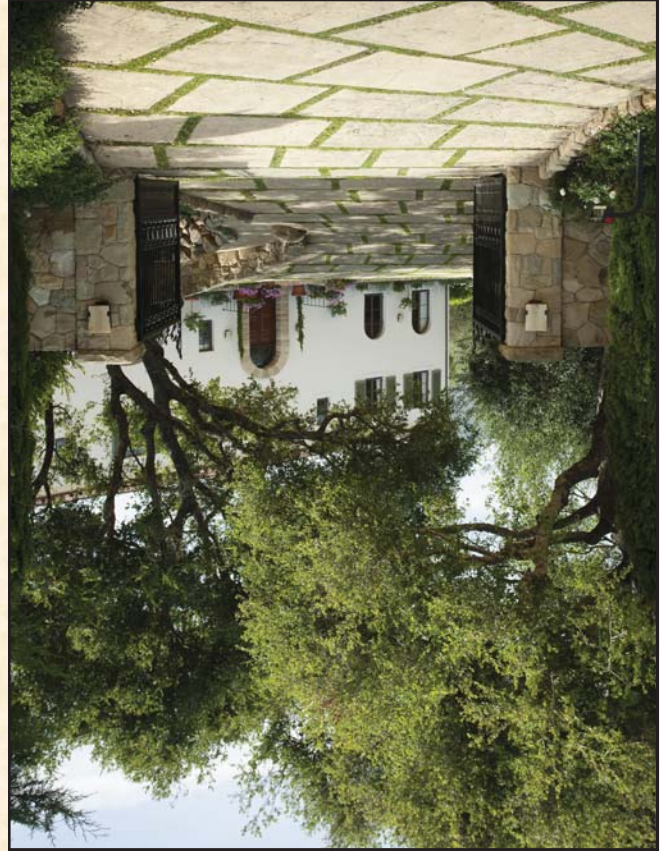

**BARBARA KOUTNIK**  
803.565.8811 OFFICE  
803.689.3015 CELL  
BKOUTNIK@AOL.COM  
WWW.BARBARAKOUTNIK.COM  
DRE# 00809916



# STONEHOUSE LANE ESTATE MONTECITO, CALIFORNIA





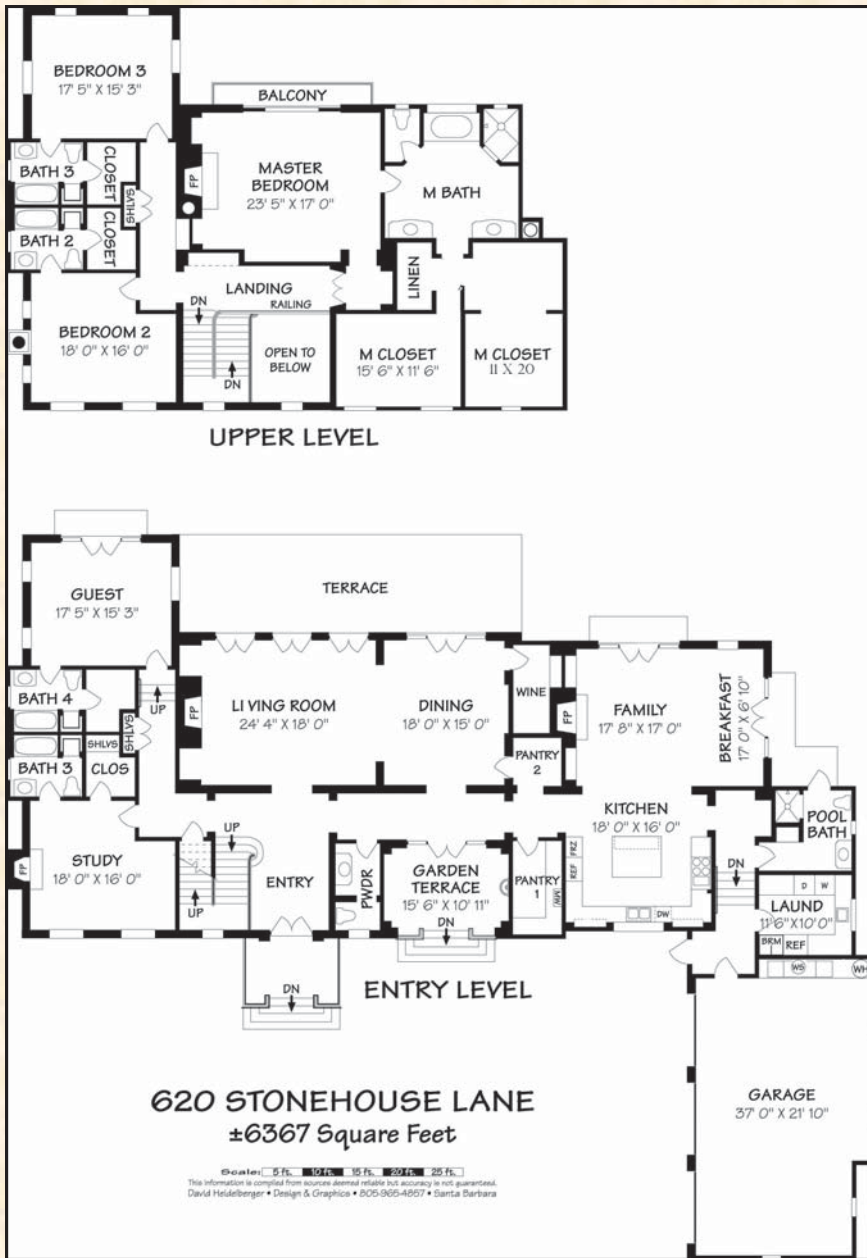

# 620 STONEHOUSE LANE

## MONTECITO, CALIFORNIA

OFFERED AT \$5,800,000

**STYLE:** TUSCAN VILLA  
**APN:** 155-060-026  
**ACREAGE:** 1.30 ACRES  
**ARCHITECT:** DON NUTLY

**BEDROOMS:** FIVE  
**BATHS:** SIX AND ONE HALF  
**AGE:** BUILT IN 2001  
**BUILDER:** TYLER CONSTRUCTION

**ENTRY: 13x17**

CUSTOM DESIGNED DOUBLE ENTRY DOORS  
 EXTERIOR STONE SURROUND OVER ENTRY DOORS  
 ANTIQUE TERRA COTTA TILE FLOORS FROM FRANCE  
 THERE IS A 23 FOOT LONG GALLERIA WITH BARREL CEILINGS OFF THE ENTRY. ARCHED FRENCH DOORS AND WINDOWS OPEN TO A PRIVATE COVERED COURTYARD PATIO WITH WALL FOUNTAIN

**POWDER BATH:**

THE VANITY IS A 400-YEAR-OLD ANTIQUE STONE BASE WITH HAND MADE BOWL BY ALCHEMY. HAND CRAFTED, WROUGHT IRON WALL SCONCES ACCENT THE WALLS. ANTIQUE TERRA COTTA TILE FLOORS.

**LIVING ROOM: 18x24.4**

FIREPLACE SURROUND IS ANTIQUE LIMESTONE OF ITALIAN ORIGIN  
 ANTIQUE TERRA COTTA TILE FLOORS  
 ARCHITECTURALLY DESIGNED CEILINGS  
 CUSTOM LIGHTING  
 SURROUND SOUND MUSIC SYSTEM  
 ALCOVE AND WIRING FOR FLAT SCREEN TELEVISION  
 FRENCH DOORS TO GARDEN AND BEAUTIFUL MOUNTAIN VIEWS

**DINING ROOM: 15x18**

CUSTOM DESIGNED ALABASTER HAND CARVED CHANDELIER  
 ANTIQUE TERRA COTTA TILE FLOORS  
 ANTIQUE CHANDELIER AND MUSIC SYSTEM  
 WALK-IN CLOSET WITH BUILT-IN WINE REFRIGERATOR  
 AND CHINA STORAGE  
 FRENCH DOORS TO GARDEN WITH MOUNTAIN VIEWS

**GARDEN TERRACE: 10.11x15.6**

COVERED TILED PATIO TERRACE  
 FRENCH DOORS FROM MAIN HALL  
 STONE FOUNTAIN

**KITCHEN 16x18**

CUSTOM ALDER CABINETS HAND-FINISHED BY MICHAEL AYERS  
 COUNTER TOPS ALL FRENCH LIMESTONE  
 CUSTOM DESIGNED HAND PAINTED TILE FROM DERUTA, ITALY  
 WOLF GOURMET RANGE WITH VENTED CUSTOM HOOD  
 SINK BY VILLEROY & BOCHE  
 BOSCH DISHWASHER  
 WARMING DRAWER  
 700 SUB ZERO REFRIGERATOR AND FREEZER UNITS  
 LARGE WALK-IN PANTRY AND ACCESS TO BUTLER'S PANTRY  
 WALNUT HARDWOOD FLOORS  
 VAULTED CEILING WITH ANTIQUE TIMBERED BEAMS  
 CUSTOM LIGHTING AND MUSIC SYSTEM  
 EXTRA FULL BATH LOCATED OFF THE KITCHEN/FAMILY ROOM WING WITH OUTDOOR ACCESS

**FAMILY ROOM: 19x23**

WALNUT HARDWOOD FLOORS  
 BUILT IN DISPLAY CASES ON EACH SIDE OF FIREPLACE  
 ANTIQUE FIREPLACE SURROUND  
 VAULTED, BARREL CEILING WITH ANTIQUE TIMBERED BEAMS  
 CUSTOM LIGHTING AND MUSIC SYSTEM  
 FLAT SCREEN TELEVISION ABOVE FIREPLACE  
 FRENCH DOOR ACCESS TO GARDEN, POOL AND TILED PATIO

**LAUNDRY ROOM: 10x11.6**

TILE FLOORS  
 EXTRA REFRIGERATOR  
 COMPUTER OR HOBBY WORK CENTER  
 EXTENSIVE STORAGE CABINETS AND LAUNDRY SINK

**FAMILY BEDROOM/STUDY: 16x18**

ANTIQUÉ ENTRY DOORS  
 LIMESTONE FLOORS WITH ANTIQUE FINISH  
 ANTIQUE FIREPLACE SURROUND  
 BUILT-IN BOOKCASES AND WALL UNIT  
 CUSTOM LIGHTING AND MUSIC SYSTEM  
 INTEGRATED COMPUTER NETWORK WHICH IS ACCESSED THROUGH A HIGH-SPEED DATA CABLE SYSTEM  
 ADJOINING TILED BATH WITH ANTIQUE APPOINTMENTS  
 CUSTOM DESIGNED WALK-IN CLOSET

**FAMILY BEDROOM: 15.3x17.5**

ANTIQUÉ ENTRY DOORS  
 CHANDELIER BY HOLLY HOCK AND MUSIC SYSTEM  
 ADJOINING TILED BATH WITH ANTIQUE APPOINTMENTS  
 SPACIOUS WALK-IN CLOSET  
 FRENCH DOORS TO GARDEN

**UPSTAIRS BEDROOM SUITES**

BEAUTIFUL WROUGHT IRON STAIRWAY WITH ANTIQUE NEWELL POSTS AND TILE STEPS WITH WOOD TRIM, LEAD YOU TO A 23-FOOT LANDING WITH WALNUT FLOORS

**MASTER BEDROOM: 17x23.5**

ANTIQUÉ ENTRY DOORS  
 BARREL CEILING WITH CUSTOM LIGHTING AND MUSIC SYSTEM  
 RAISED HEARTH FIREPLACE  
 ANTIQUÉ DOORS FOR TELEVISION CLOSET  
 CUSTOM DESIGNED LIGHT FIXTURES  
 FRENCH DOORS LEAD TO TILED BALCONY TO VIEW THE MOUNTAINS AND GARDENS



**MASTER BATH: 17x17**

ANTIQUÉ ENTRY DOOR  
 MASTER BATH HAS RADIANT HEATED TILE FLOORS ON AUTOMATIC TIMER SYSTEM  
 LIMESTONE TILED STEAM SHOWER  
 SEPARATE COMMODE ROOM  
 WATER WORKS SOAKING TUB WITH LIMESTONE SURROUND AND INLAYED ANTIQUE TILES  
 TWO ARCHITECTURALLY DESIGNED FREE-STANDING VANITIES  
 ARTEMIDE JEWELLED LIGHT FIXTURES  
 11X20 WALK-IN CLOSET WITH CUSTOM DESIGNED CABINETS  
 ADDITIONAL CEDAR LINED CLOSET

**CLOSET OR GYM: 11x16**

CURRENTLY USED AS AN ADDITIONAL CUSTOM DESIGNED WALK-IN CLOSET. THIS ROOM HAS SURROUND SOUND SPEAKER SYSTEM, PRE-WIRED FOR FLAT SCREEN TELEVISION AND TWO LARGE WEST FACING WINDOWS

**FAMILY BEDROOM: 16x18**

ANTIQUÉ ENTRY DOORS  
 SPACIOUS ROOM FILLED WITH LIGHT TO VIEW THE GARDENS  
 CUSTOM LIGHTING AND MUSIC SYSTEM, COVED CEILING  
 ADJOINING TILED BATH WITH ANTIQUE APPOINTMENTS  
 SPACIOUS WALK-IN CLOSET AND LINEN STORAGE

**FAMILY BEDROOM: 15.3x17.5**

ANTIQUÉ ENTRY DOORS  
 SPACIOUS ROOM FILLED WITH WRAP AROUND WINDOWS  
 CUSTOM LIGHTING AND MUSIC SYSTEM  
 ADJOINING TILED BATH WITH ANTIQUE APPOINTMENTS  
 SPACIOUS WALK-IN CLOSET AND LINEN STORAGE

**ADDITIONAL CUSTOM FEATURES:**

- CUSTOM REGGIO IRON REGISTERS THROUGHOUT
- QUAD SHIELDED RG6 WIRING
- ENHANCED CAT 5 FOR TELEPHONE NETWORK
- PANASONIC DIGITAL PHONE SYSTEM
- ELECTRIC GATE ENTRY PRE-WIRED FOR SECURITY CAMERA
- PLUMBED FOR CENTRAL VACUUM SYSTEM
- TWO FAG UNITS AND TWO CENTRAL AIR-CONDITIONING UNITS
- CUSTOM TOUCH-TONE DIMMER LIGHTING SYSTEM THROUGHOUT
- OUTDOOR BBQ WITH 53" VIKING COOKING CENTER, AND INTEGRATED MUSIC SYSTEM
- LOW VOLTAGE LANDSCAPE LIGHTING SYSTEM
- POOL AND SPA WITH CASCADING WATER FEATURE
- ALL INTERIOR DOORS ARE ALDER
- ALL EXTERIOR DOORS AND WINDOWS ARE CEDAR. SHUTTERS ARE CAPPED IN COPPER WITH COPPER RAIN GUTTERS
- CUSTOM DESIGNED STEREO SYSTEM
- FULLY WIRED SECURITY SYSTEM